

TL 싱크로 폴리 표준치수표 (축홀가공 타입)

H형

(폴리 치형 치수)

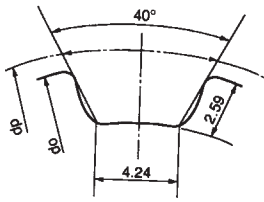

(폴리 호칭)

15 H 100 A
 폴리 형상 (A형)
 폴리 호칭폭
 (벨트폭 1인치 : 25.4mm용)
 폴리 치형 (H형)
 폴리 잇수 (15개)

(폴리 형상)
 A 형

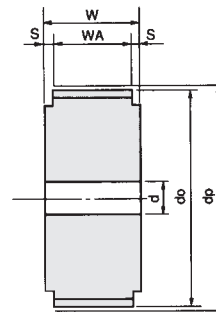

B 형

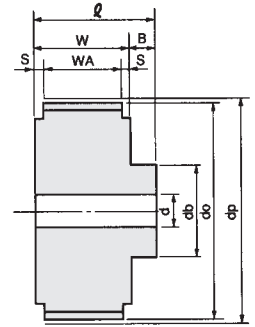

H100 (벨트폭 : 25.4mm용)

는 재고판매 하고 있습니다.

단위 : mm

잇수	형상	재질	dp	do	W	ℓ	WA	S	B	db	d			폴리에상 질량 (kg)		플랜지 품 번	
											MAX		MIN	A	B, B ₁		
											A	B, B ₁	A, B, B ₁		A		B, B ₁
14	A, B	기계 구조용 탄소강강재	56.60	55.22	32	47	27	2.5	15	39	35	26	15	0.50	0.62	F 6146	
15	A, B		60.64	59.27	32	47	27	2.5	15	45	38	30	15	0.58	0.75	F 6751	
16	A, B		64.68	63.31	32	47	27	2.5	15	48	42	30	15	0.68	0.87	F 7056	
18	A, B		72.77	71.39	32	47	27	2.5	15	50	48	32	15	0.88	1.0	F 7761	
19	A, B		76.81	75.44	32	47	27	2.5	15	50	52	32	15	1.0	1.2	F 8366	
20	A, B		80.85	79.48	32	47	27	2.5	15	56	55	38	15	1.1	1.3	F 8871	
21	A, B		84.89	83.52	32	47	27	2.5	15	56	58	38	15	1.2	1.5	F 9575	
22	A, B		88.94	87.56	32	47	27	2.5	15	56	62	38	15	1.3	1.6	F 9575	
24	A, B		97.02	95.65	32	47	27	2.5	15	56	68	38	15	1.6	1.9	F 10385	
25	A, B		101.06	99.69	32	47	27	2.5	15	63	72	38	20	1.7	2.1	F 11190	
26	A, B	강강재	105.11	103.73	32	47	27	2.5	15	63	75	38	20	1.9	2.2	F 11190	
28	A, B		113.19	111.82	32	47	27	2.5	15	63	82	38	20	2.2	2.6	F119100	
30	A, B		121.28	119.90	32	47	27	2.5	15	63	88	38	20	2.6	2.9	F127105	
32	A, B		129.36	127.99	32	47	27	2.5	15	63	95	38	20	3.0	3.3	F135115	
34	A, B		137.45	136.07	32	47	27	2.5	15	63	102	38	20	3.4	3.7	F144125	
36	A, B		145.53	144.16	32	47	27	2.5	15	71	108	40	20	3.8	4.3	F152130	
40	B ₁	회주철	161.70	160.33	32	47	—	—	15	90	—	52	20	—	5.5	—	
42	B ₁		169.79	168.41	32	47	—	—	15	90	—	52	25	—	6.0	—	
44	B ₁		177.87	176.50	32	47	—	—	15	90	—	52	25	—	6.5	—	
48	B ₁		194.04	192.67	32	47	—	—	15	90	—	52	25	—	7.7	—	
50	B ₁		202.13	200.76	32	47	—	—	15	90	—	52	25	—	8.3	—	
60	B ₁		242.55	241.18	32	47	—	—	15	90	—	52	30	—	11.7	—	
72	B ₁		291.06	289.69	32	47	—	—	15	90	—	52	30	—	16.7	—	
84	B ₁		339.57	338.20	32	47	—	—	15	90	—	52	30	—	22.7	—	
96	B ₁		388.08	386.71	32	47	—	—	15	90	—	52	30	—	29.6	—	

H150 (벨트폭 : 38.1mm용)

는 재고판매 하고 있습니다.

단위 : mm

잇수	형상	재질	dp	do	W	ℓ	WA	S	B	db	d			폴리 예상 질량 (kg)		플랜지 품 번	
											MAX		MIN	A	B, B1		
											A	B, B1	A, B, B1		A		B, B1
14	A, B	기계 구조용 탄소강강재	56.60	55.22	45	60	40	2.5	15	39	35	26	15	0.70	0.82	F 6146	
15	A, B		60.64	59.27	45	60	40	2.5	15	45	38	30	15	0.82	0.99	F 6751	
16	A, B		64.68	63.31	45	60	40	2.5	15	48	42	30	15	0.95	1.1	F 7056	
18	A, B		72.77	71.39	45	60	40	2.5	15	50	48	32	15	1.2	1.4	F 7761	
19	A, B		76.81	75.44	45	60	40	2.5	15	50	52	32	15	1.4	1.6	F 8366	
20	A, B		80.85	79.48	45	60	40	2.5	15	56	55	38	15	1.5	1.8	F 8871	
21	A, B		84.89	83.52	45	60	40	2.5	15	56	58	38	15	1.7	2.0	F 9575	
22	A, B		88.94	87.56	45	60	40	2.5	15	56	62	38	15	1.9	2.2	F 9575	
24	A, B		97.02	95.65	45	60	40	2.5	15	56	68	38	15	2.3	2.6	F 10385	
25	A, B		101.06	99.69	45	60	40	2.5	15	63	72	38	20	2.5	2.8	F 11190	
26	A, B	회주철	105.11	103.73	45	60	40	2.5	15	63	75	38	20	2.7	3.0	F 11190	
28	A, B		113.19	111.82	45	60	40	2.5	15	63	82	38	20	3.1	3.5	F119100	
30	A, B		121.28	119.90	45	60	40	2.5	15	63	88	38	20	3.7	4.0	F127105	
32	A, B		129.36	127.99	45	60	40	2.5	15	63	95	38	20	4.2	4.5	F135115	
34	A, B		137.45	136.07	45	60	40	2.5	15	63	102	38	20	4.8	5.1	F144125	
36	A, B		145.53	144.16	45	60	40	2.5	15	71	108	40	20	5.4	5.8	F152130	
40	B1		161.70	160.33	45	60	—	—	15	90	—	52	20	—	7.5	—	
42	B1		169.79	168.41	45	60	—	—	15	90	—	52	25	—	8.1	—	
44	B1	177.87	176.50	45	60	—	—	15	90	—	52	25	—	8.9	—		
46	B1	185.96	184.59	45	60	—	—	15	90	—	52	25	—	9.7	—		
48	B1	회주철	194.04	192.67	45	60	—	—	15	90	—	52	25	—	10.5	—	
50	B1		202.13	200.76	45	60	—	—	15	90	—	52	25	—	11.4	—	
60	B1		242.55	241.18	45	60	—	—	15	90	—	52	30	—	16.2	—	
72	B1		291.06	289.69	45	60	—	—	15	90	—	52	30	—	23.3	—	
84	B1		339.57	338.20	45	60	—	—	15	90	—	52	30	—	31.7	—	
96	B1		388.08	386.71	45	60	—	—	15	90	—	52	30	—	41.4	—	